

BOX

Cod.43166/43167

BOX_DICRO SOFFITTO ORIENT. GU10

100-240VAC MAX 50W

LOGICA

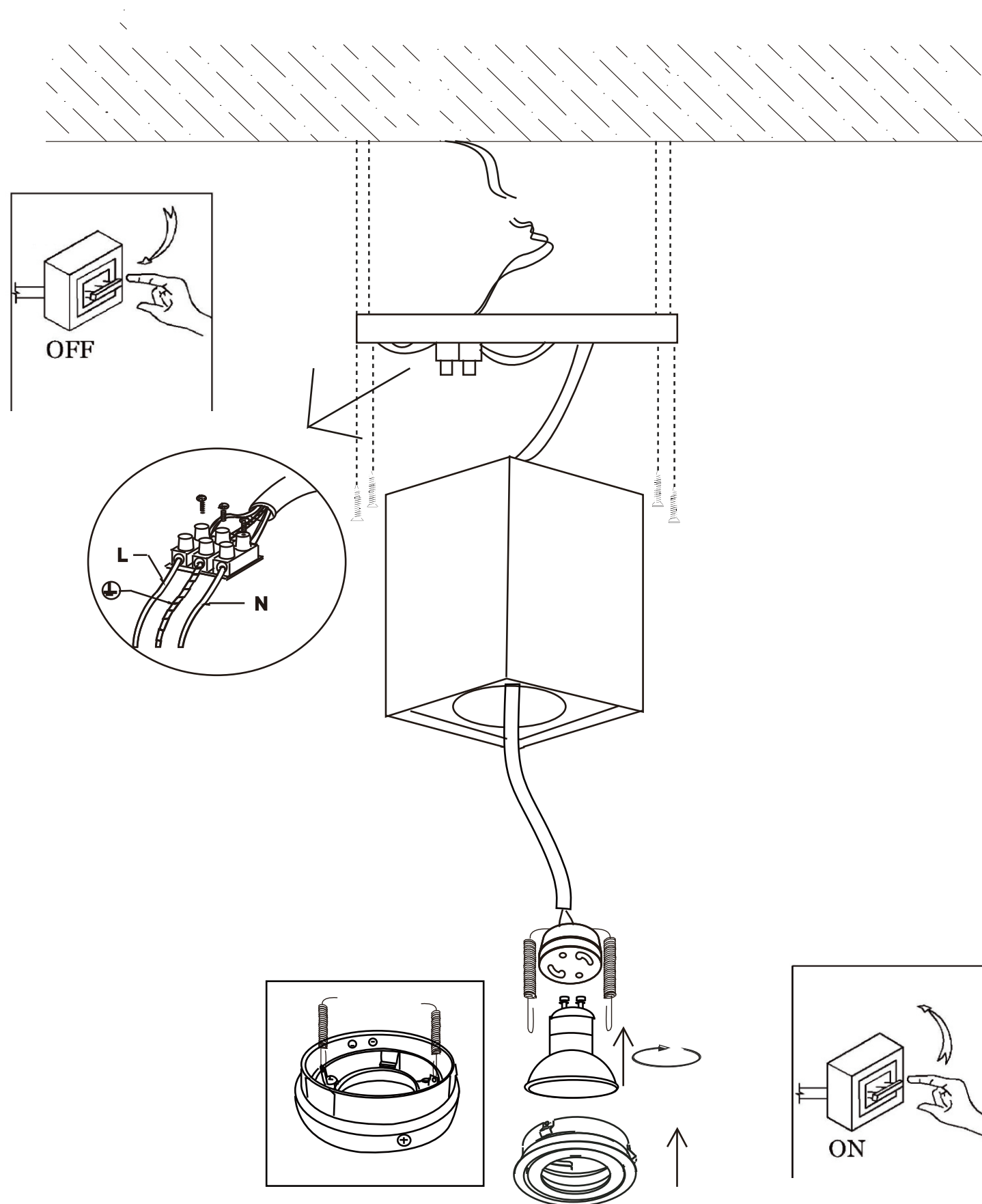

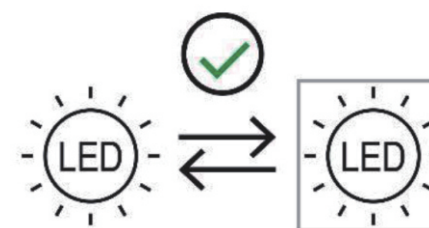

BOX

LOGICA



Replaceable (LED only) light source by
an end-user

1. Togliere tensione prima dell'installazione o qualsiasi manutenzione.
2. L'installazione e la manutenzione devono essere affidate a personale qualificato e devono essere eseguite conformemente alle prescrizioni delle vigenti normative impianti.
3. Questo apparecchio è compatibile con Sorgenti Luminose di Classe Energetica da E a A++ (EU 874/2012) e dal 01.09.2021 con Classe Energetica da G a A (EU2019/2015)
4. Il simbolo  riportato sull'apparecchio indica che il prodotto deve essere smaltito in modo differenziato dai rifiuti urbani
5. Disconnect the power supply before installation or any maintenance work.
6. Installation and maintenance must be carried by qualified personnel and according to the current Directives on electrical systems.
7. This luminaire is compatible with Lighting Sources with Class Energy E to A++ (EU874/2012) and from 01.09.2021 with Class Energy from G to A (EU2019/2015)
8. This symbol  shown on the device indicates that the product must be dispose of in a way which differs from the standard urban rubbish.

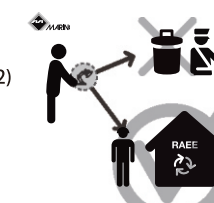

LOGICA è un marchio



MARINO CRISTAL SPA
Via Guardia del Consiglio, 30
47899 Serravalle Repubblica di San Marino
el. 0549 901188 - Fax 0549 900612
www.marinocristal.com

